

Feb. 2, 1883.

08484

Offsets to determine the lines of Olney Street
as shown in Street Book 1, page 95, also St. Plats A, page 18.
taken Oct. 1881. by F. B. B. Scale 80 ft. per inch.

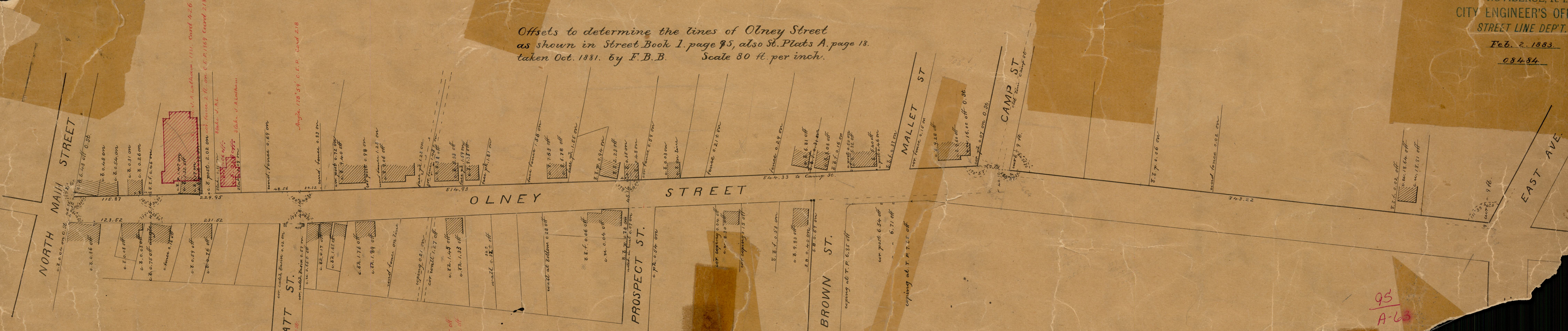

Angle 178° 59' C. E. P. Card 218

Stake J. A. L. Stake J. A. L. Stake J. A. L.

Angle 178° 59' C. E. P. Card 218

Stake J. A. L. Stake J. A. L. Stake J. A. L.

95
A-63